

Rear Suspension

Index-2WS

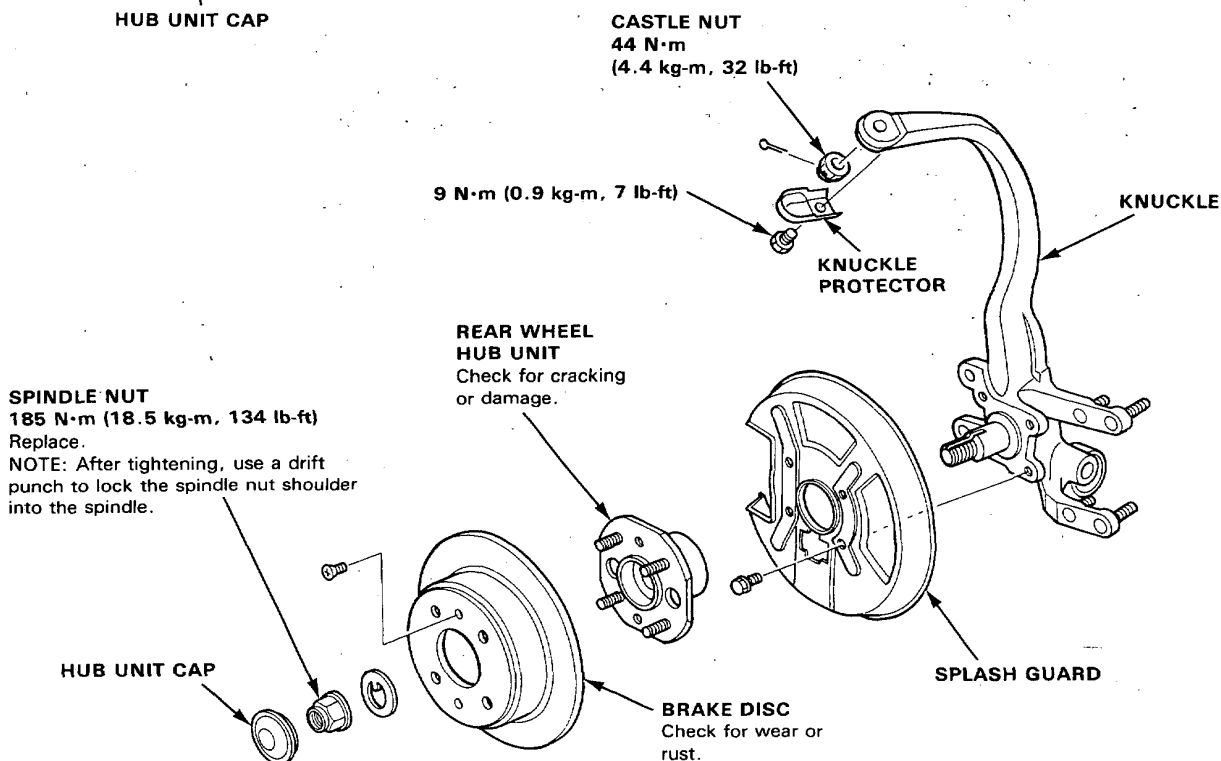

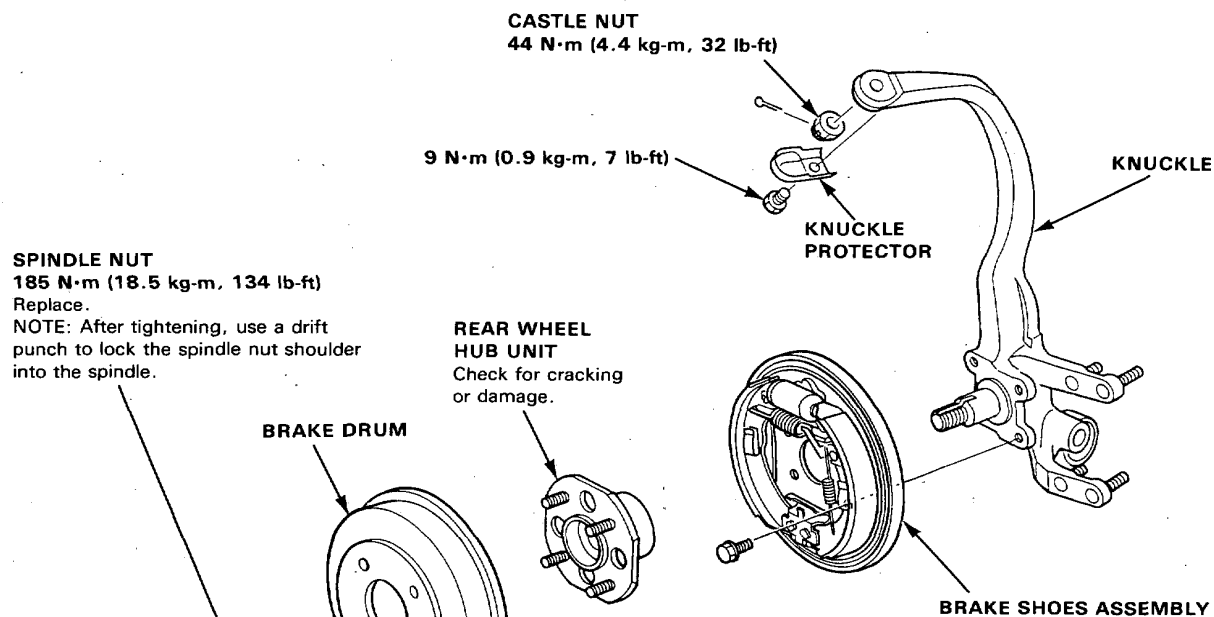

Knuckle/Hub Replacement-4WS

1. Pry the spindle nut stake away from the spindle, then loosen the nut.

SPINDLE NUT

22 x 1.5 mm

185 N·m (18.5 kg-m, 134 lb-ft)

Replace.

NOTE: After tightening, use a drift punch to stake the spindle nut shoulder onto the spindle.

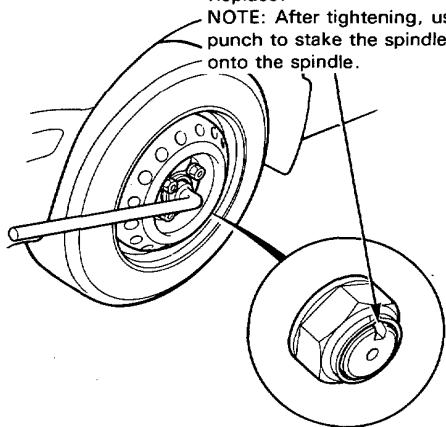

2. Loosen the wheel nuts slightly.
3. Raise the front of car and support on safety stands in proper locations.
4. Remove the wheel nuts, wheel, and spindle nut.
5. Remove the caliper bolts and hang the caliper assembly to one side.

CAUTION: To prevent accidental damage to the caliper assembly or brake hose, use a short piece of wire to hang the caliper assembly from the undercarriage.

6. Remove the caliper mounting bracket.

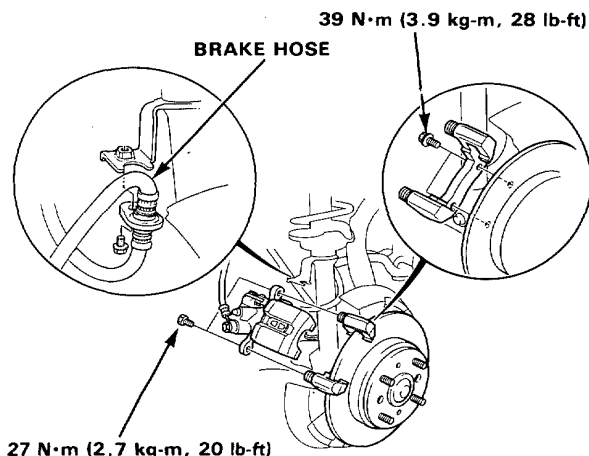

7. Remove the 6 mm brake disc retaining screws.
8. Screw two 8 x 1.0 mm bolts into the disc to push it away from the hub.

NOTE: Turn each bolt two turns at a time to prevent cocking disc excessively.

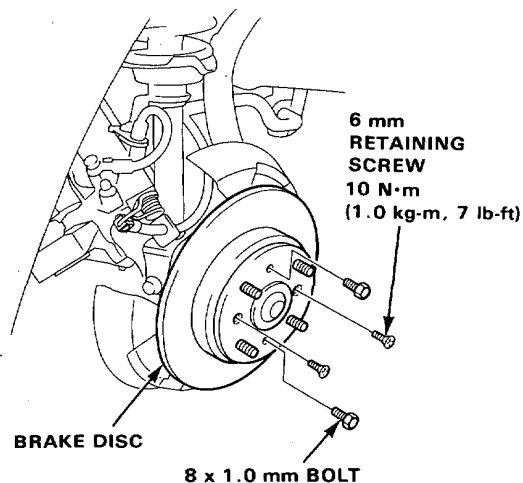

9. Remove the hub bearing unit.
10. Remove the splash guard screws from the knuckle.

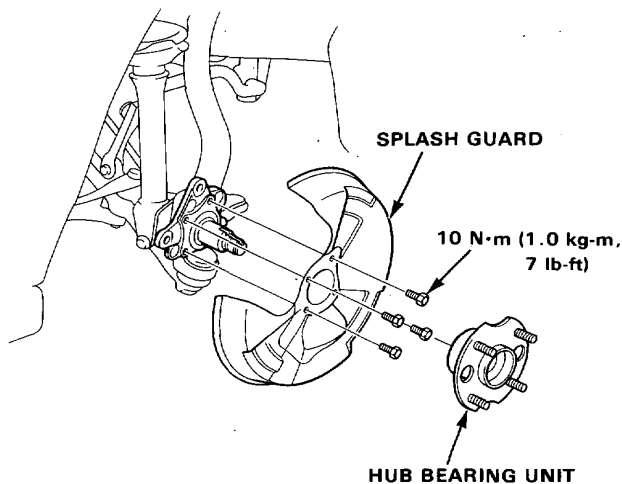

(cont'd)